

TERMINAL LEAD DETAIL

REVISIONS				
CHANGE ORDER	LTR	DESCRIPTION	DATE	APPROVED
Q08023	1	PAG 46 was PAG 100	08/22/08	
Q09035	2	ADDED TOLERANCES & PART NO'S	09/14/09	
Q11002	3	ADDED PRV & LOCATING DIMS	03/14/11	
ENG	4	REVISED MOUNTING DIMS TO 'HA'	05/10/11	
ENG	5	GAGE LINE: 44.2 WAS 39.6	05/19/11	

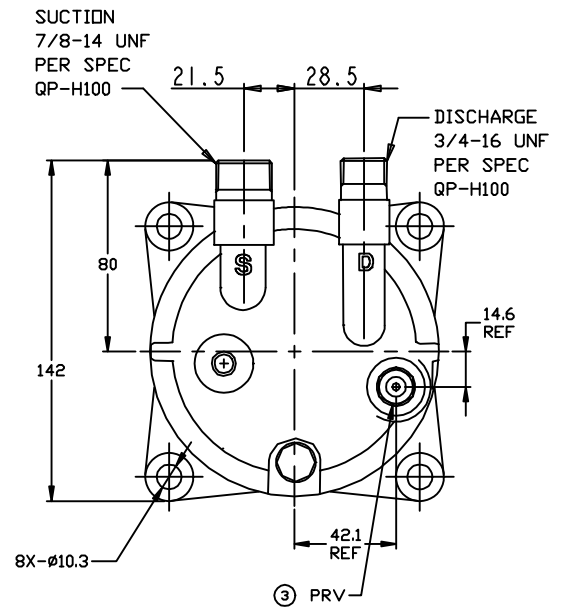
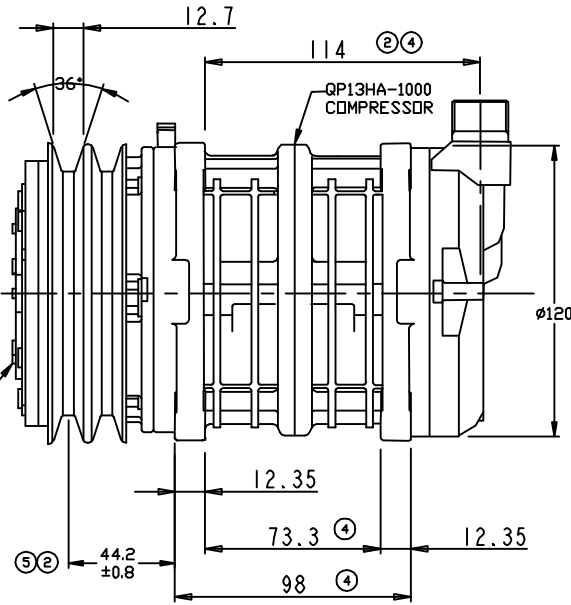
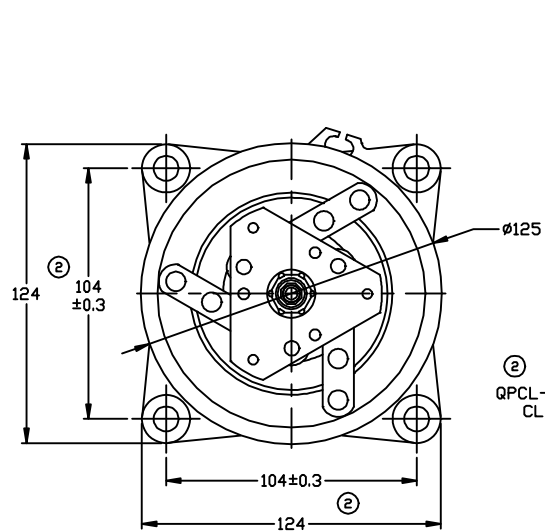

- CLUTCH SPECIFICATIONS:**
- VOLTAGE..... 12 VDC
 - BELT..... A2
 - STATIC TORQUE
INITIAL..... 35 Nm (3.5 Kgf)
AFTER BURNISHING..... 49 Nm (5 Kgf)
 - MAX POWER CONSUMPTION..... 45W @ 25°C
 - ROTATION DIRECTION..... CW OR CCW
 - WEIGHT..... 2.30 Kg

- COMPRESSOR SPECIFICATIONS:**
- MODEL..... QP13HA
 - NUMBER OF CYLINDERS..... 6
 - BORE X STROKE..... 36 X 21.4 mm
 - DISPLACEMENT..... 131 cm³/REV
 - SPEED RANGE..... 700 - 6000 RPM
 - ROTATION DIRECTION..... CW OR CCW
 - REFRIGERANT..... R-134a
 - LUBRICANT..... PAG 46 150+20cm3
 - WEIGHT..... 4.4 Kg

THIRD ANGLE PROJECTION	UNLESS OTHERWISE SPECIFIED DIMENSIONS ARE IN MM. INTERPRET DIM AND TOL PER ASME Y14.5M - 1994		CAD GENERATED DRAWING. DO NOT MANUALLY UPDATE	
	DRAWN	GLB	DATE	08/07/07
	CHECKED			
	APPROVED			
FINISH		ENG APPVL		

QUE PRODUCTS, LLC
DECATUR, ILLINOIS

TITLE: COMPRESSOR ASSEMBLY
QP13HA MONO V-3/4 7/8
A2 125mm 12V LEAF SPRING

SIZE A	CODE IDENT NO	DWG NO	REV 5
SCALE NONE	SHEET 1 OF 1		