

REVISIONS		DESCRIPTION	DATE	APPROVED
CHANGE ORDER	LTR			
ENG	1	REVISED DRAWING FORMAT	02/19/08	
008023	2	PAG 46 WAS PAG 100 008023	08/15/08	
009035	3	ADDED TOLERANCES & PART NDS	11/04/09	

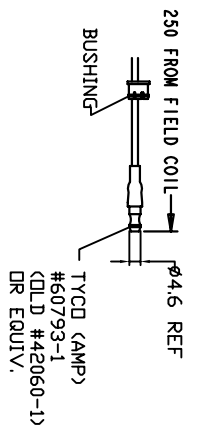

TERMINAL LEAD DETAIL

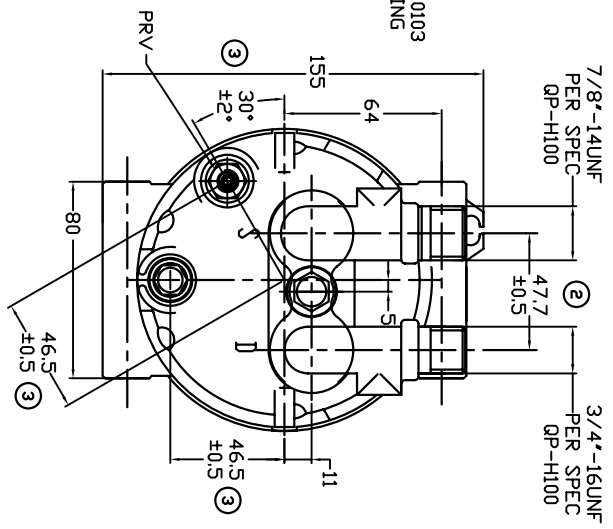
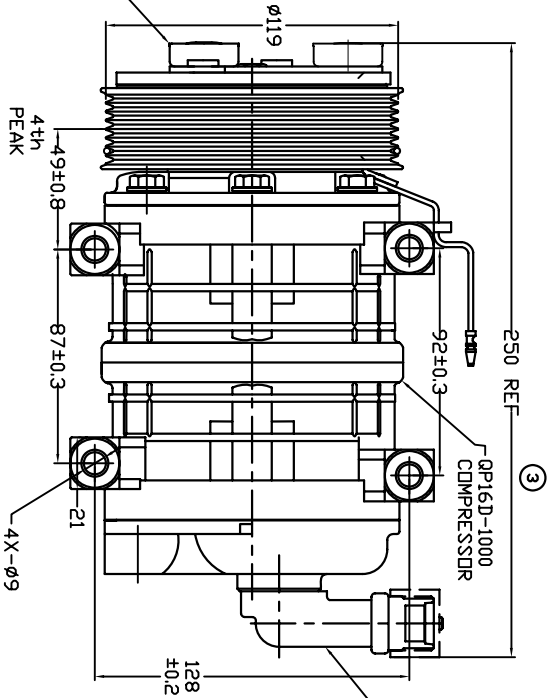
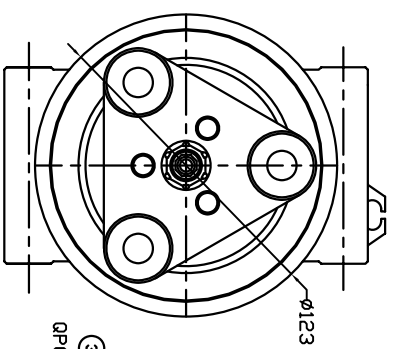

CLUTCH SPECIFICATIONS:

- VOLTAGE..... 12 VDC
- BELT..... PV8
- STATIC TORQUE..... 35 Nm (3.5 kgfm)
- INITIAL AFTER BURNISHING..... 49 Nm (5 kgfm)
- MAX POWER CONSUMPTION..... 45W @ 25°C
- ROTATION DIRECTION..... CW OR CCW
- WEIGHT..... 2.25 Kg

COMPRESSOR SPECIFICATIONS:

- MODEL..... QP16HD
- NUMBER OF CYLINDERS..... 6
- BORE X STROKE..... 36 X 26 3/4 mm
- DISPLACEMENT..... 162.9 cm³/REV
- SPEED RANGE..... 700 - 6000 RPM
- ROTATION DIRECTION..... CW
- REFRIGERANT..... R-134g
- LUBRICANT..... PAG 46 180+20cm³
- WEIGHT..... 4.7 Kg

UNLESS OTHERWISE SPECIFIED DIMENSIONS ARE IN MM. PER INTERPRET DIM AND TOL. PER ASME Y14.5M - 1994

THIRD ANGLE PROJECTION



DOLE PRODUCTS, LLC

TITLE: COMPRESSOR ASSEMBLY

QP16HD V-3/4 7/8
PV8 119mm 12V 3-EYE

SIZE: A
SCALE: NONE

CODE IDENT NO: QP16-1641
DWG NO: SHEET 1 OF 1

CAD GENERATED DRAWING DO NOT MANUALLY UPDATE	DATE
DRAWN G.L.B.	08/09/07
CHECKED	
APPROVED	
ENG APPVL	

